

SURVEYOR'S CERTIFICATE

I hereby certify that the boundaries of the lands to be subdivided as shown on this plan, and their relationship to the adjacent lands are correctly and accurately shown.

Martin W. Knisley
O.L.S.

LEGEND

Boundary of Subdivision
Pavement (diagrammatic only)

OWNERS AUTHORIZATION

We, STONEBROOK MARKDALE DEVELOPMENTS III INC. hereby authorize GEORGIAN PLANNING SOLUTIONS and DESIGN PLAN SERVICES INC. to prepare a draft plan of subdivision for submission and approval.

Remo Nicefora
(President)

0 10 20 30 40
metric scale

Markdale Golf & Country Club

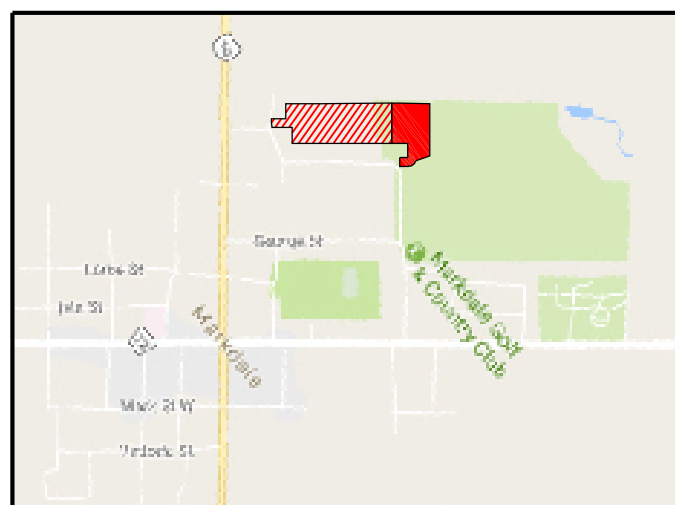

KEY PLAN

Subject
Property

0 100 200 300 400 500
approx. scale

AREA TABLE

On Street Townhouses	Blocks 1-5	0.68ha±
Residential Reserve	Blocks 6-8	0.02
Future Development	Block 9	0.07
0.3m Reserve	Block 10	0.01
Roads	Streets A & B - 20m R.O.W. @ 212m	0.42
TOTAL		1.20ha±

UNIT COUNT

6.0m (20') On Street Townhouse	16u
8.3m (27') On Street Townhouse	8
TOTAL	24u

ADDITIONAL INFORMATION REQUIRED UNDER THE PLANNING ACT

- D. Residential on street townhouses & reserve.
- H. Piped water to be provided.
- I. Primarily clay loam.
- K. Sanitary and storm sewers to be provided.

NOTES

All measurements are in metres.
All elevations refer to Geodetic Datum.

GEORGIAN PLANNING
SOLUTIONS

DRAFT PLAN of PROPOSED SUBDIVISION PART of LOT 98, CON. 1

(Geographic Township of Artemesia)

MUNICIPALITY of GREY HIGHLANDS
COUNTY of GREY

DESIGN PLAN SERVICES INC.
Town Planning Consultants

900 The East Mall, Suite 100
Etobicoke, Ontario M9B 6K2
Telephone (416) 626-5445
Fax. (416) 620-6665
www.designplan.ca

DESIGN
PLAN
SERVICES
TOWN
PLANNING
CONSULTANTS

1:1000 Scale
Dec. 20/17 Date
16142-21 Drawing Number
Hp Wb Rev. Drawn Design