

CAUTION:
THE POSITION OF POLE LINES, CONDUITS, WATERMAINS, SEWERS AND OTHER UNDERGROUND AND OVERGROUND UTILITIES AND STRUCTURES IS NOT NECESSARILY SHOWN ON THE DRAWINGS, AND, WHERE SHOWN, THE ACCURACY OF THE POSITION OF SUCH UTILITIES AND STRUCTURES IS NOT GUARANTEED. BEFORE STARTING WORK, THE CONTRACTOR SHALL INFORM HIMSELF OF THE EXACT LOCATION OF ALL SUCH UTILITIES AND STRUCTURES, AND SHALL ASSUME ALL LIABILITY FOR DAMAGE TO THEM.

Notes

1. TOPOGRAPHICAL SURVEY DERIVED FROM FIELD SURVEY BY WSP CANADA INC, COMPLETED ON OCTOBER 24, 2016.
2. PROPERTY BOUNDARY IS APPROXIMATE ONLY AND IS DERIVED FROM INFORMATION SHOWN ON PLAN OF SURVEY BY ALEX WILSON O.L.S. DATED FEBRUARY 21, 1975.

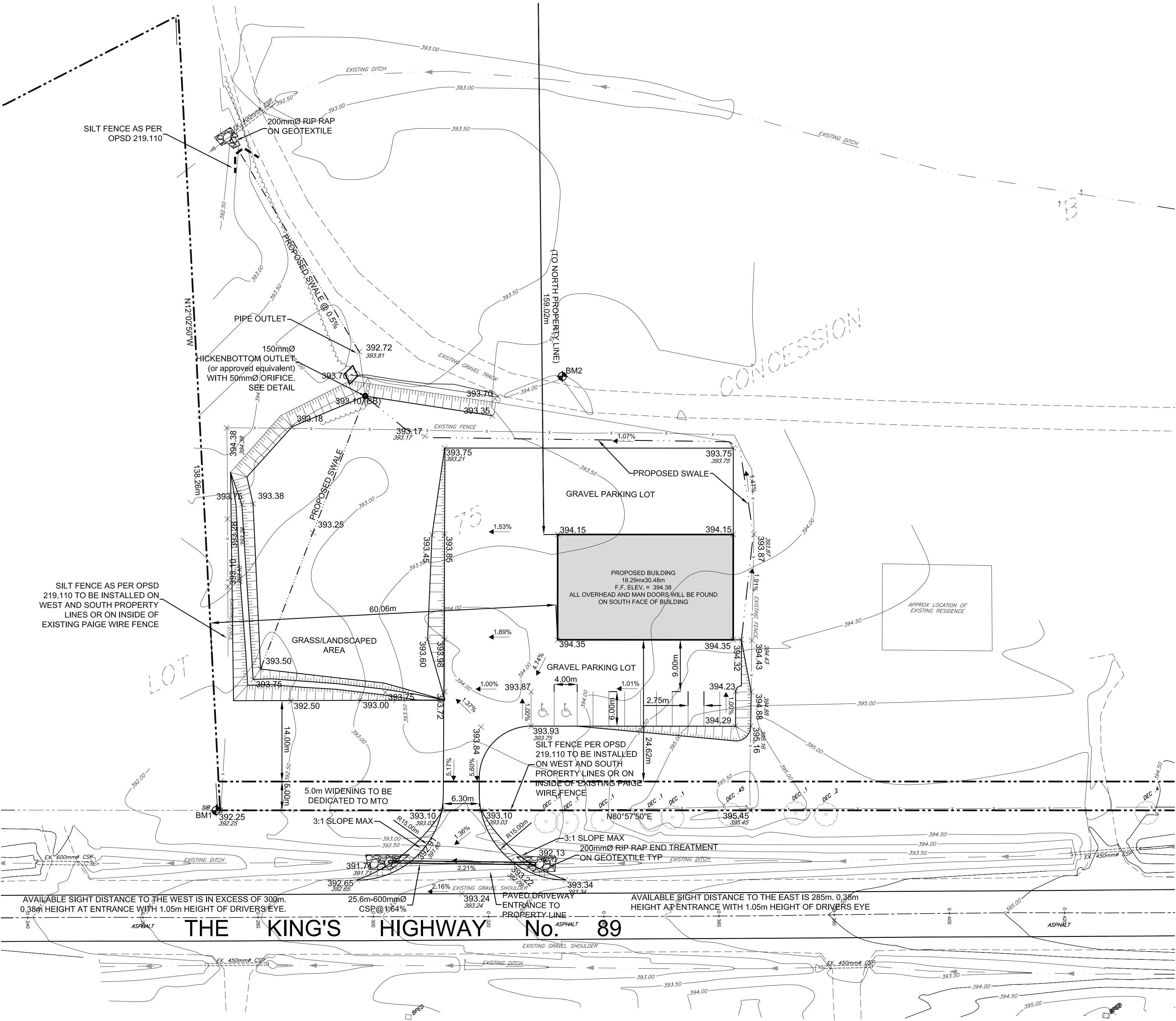
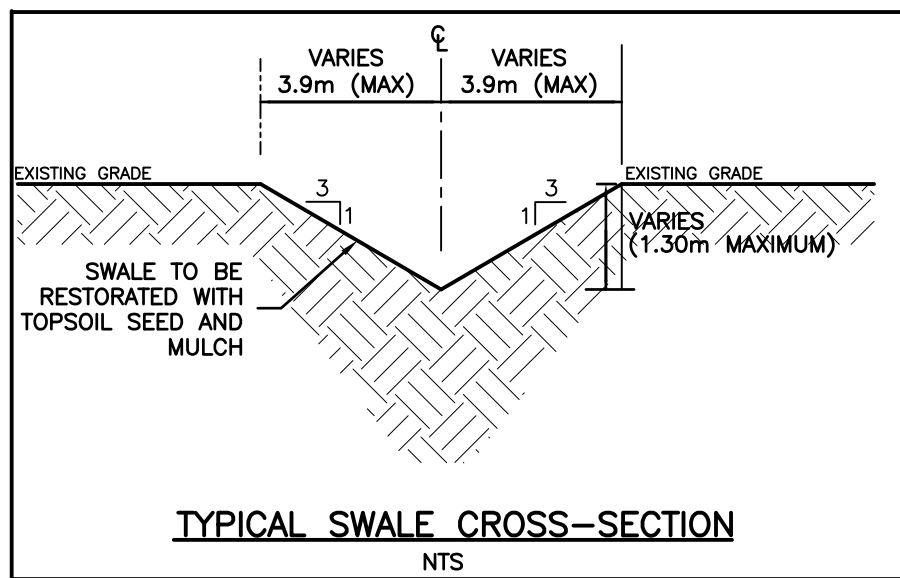

Benchmark Information

BM1	TOP OF SIB LOCATED AT THE SOUTHWEST PROPERTY CORNER.	ELEVATION	392.30m
BM2	TOP OF WOOD STAKE.	ELEVATION	394.40m

No.	DATE	DESCRIPTION	BY	APPROVED
4	JUL 7/17	FOURTH SUBMISSION	SJC	SJC
3	JUN 29/17	THIRD SUBMISSION	SJC	SJC
2	MAY 23/17	SECOND SUBMISSION	SJC	SJC
1	NOV 23/16	LAND USE PERMIT APPLICATION SUBMISSION	JAH	SJC
0	NOV 15/16	SITE PLAN SUBMISSION	JAH	SJC

REVISION / ISSUE

Seal not valid unless signed and dated



Part of Lot 75 Concession B
Geographic Township of Normanby
Municipality of West Grey
Grading and Drainage Plan

Client:		Mr. M. Martin	
Design:	JAH	Scale:	1:400
Drawn:	JAF	Approved:	
Checked:	SJC		
Date:	OCT 2016		Design Engineer
DRAWING No.		01602-GD1	

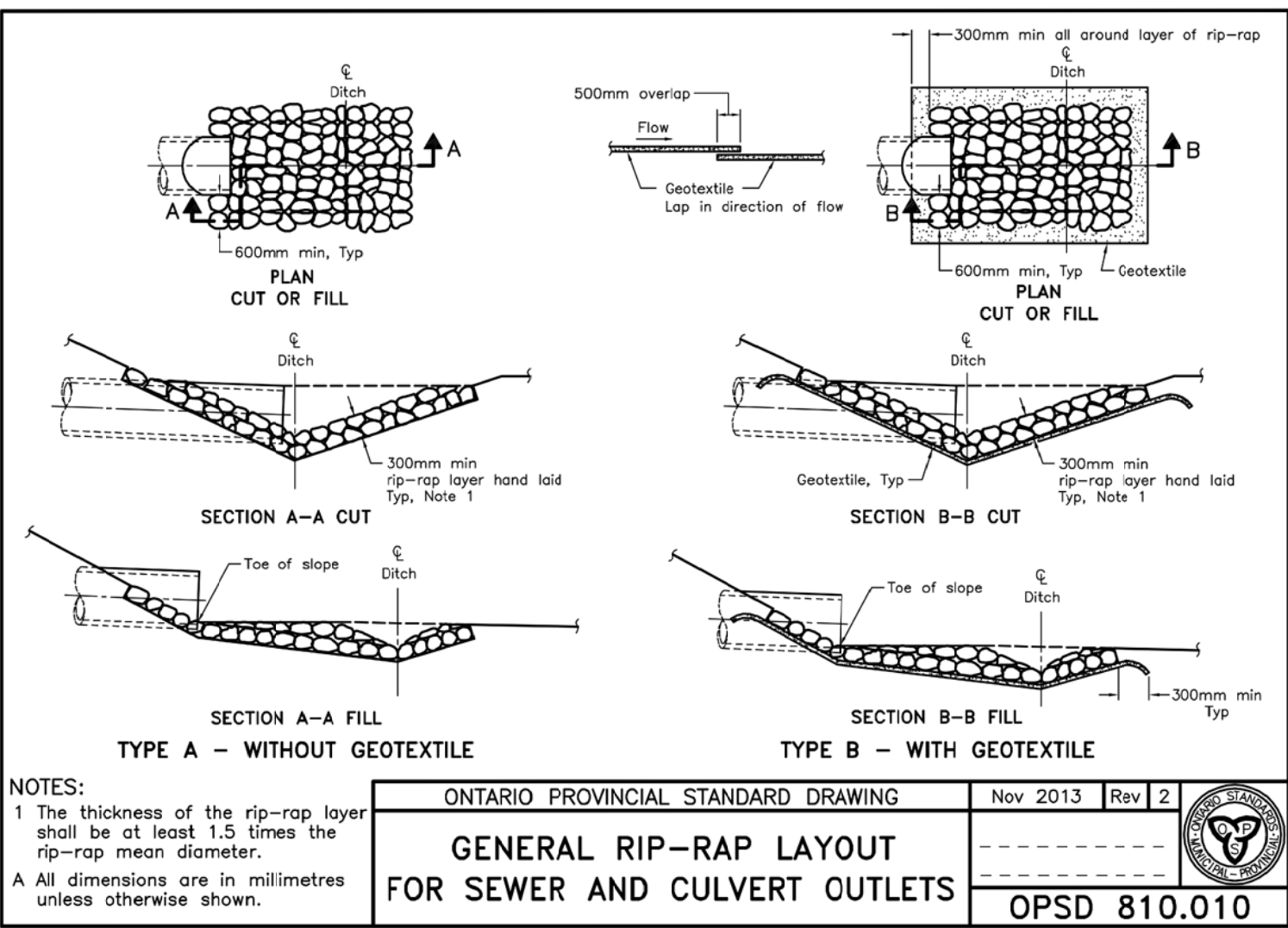

NOTES: 1 The thickness of the rip-rap layer shall be at least 1.5 times the rip-rap mean diameter. A All dimensions are in millimetres unless otherwise shown.	ONTARIO PROVINCIAL STANDARD DRAWING Nov 2013 Rev 2	OPSD 810.010
--	--	--------------