







**OFFICIAL PLAN AMENDMENT
NUMBER 16**

to the
GREY COUNTY OFFICIAL PLAN
High Potential Mineral Aggregate

SCHEDULE A

LEGEND

-  Lands Subject to Official Plan Amendment
-  Lands to be Licensed
-  Aggregate Resource Area
-  Mineral Resource Extraction;
Licensed Pits and Quarries

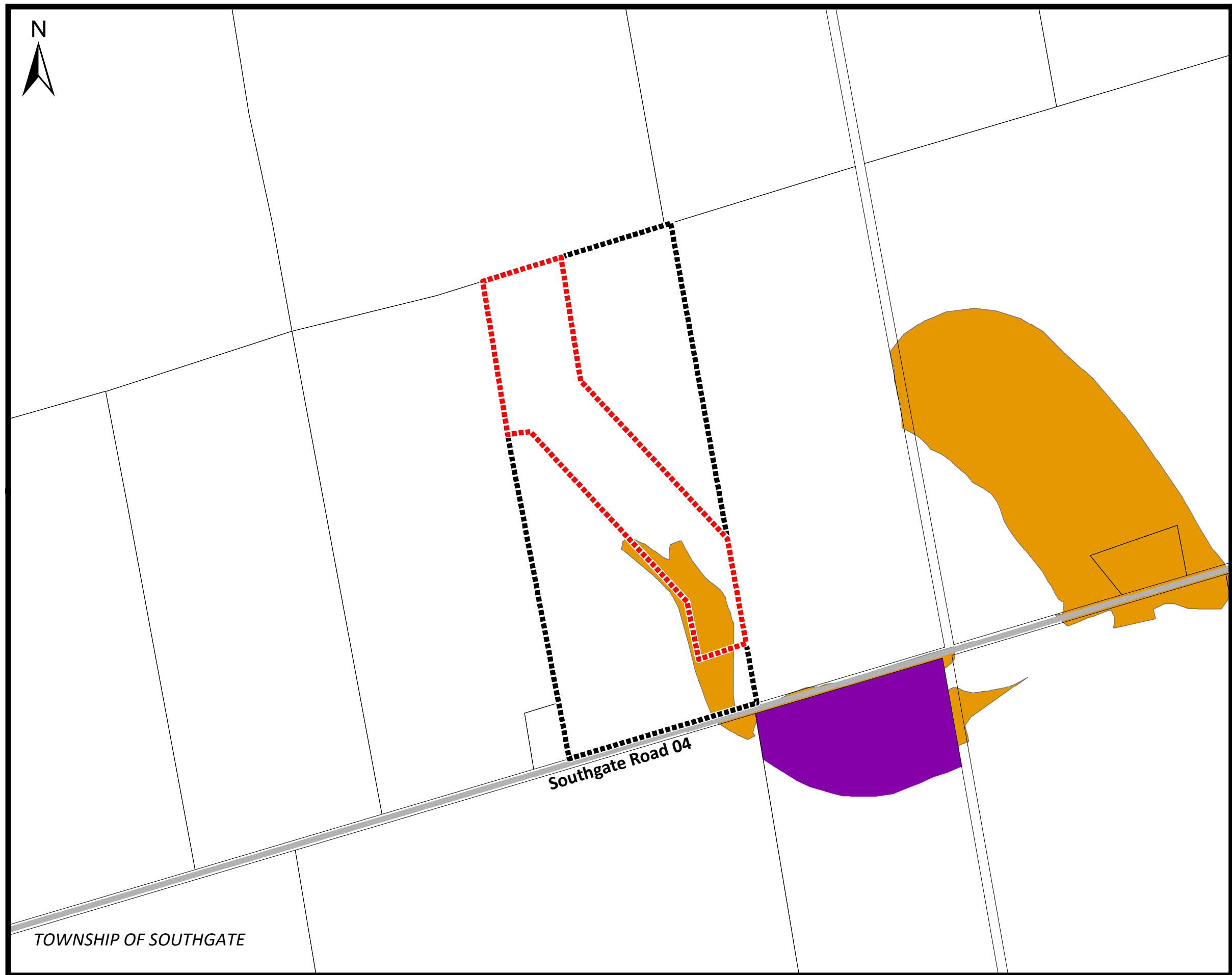

BY-LAW NUMBER _____

SCALE = 1:8,000

GREY COUNTY PLANNING & DEVELOPMENT
2022 - 11X17 - OPA16_SchedB_Proton.mxd

Please be aware this map is for illustrative purposes only. Do not rely on this map as being a precise indicator of routes, location of features or surveying purposes. This map may contain cartographic errors or omissions