

BLUE BAY VILLAS

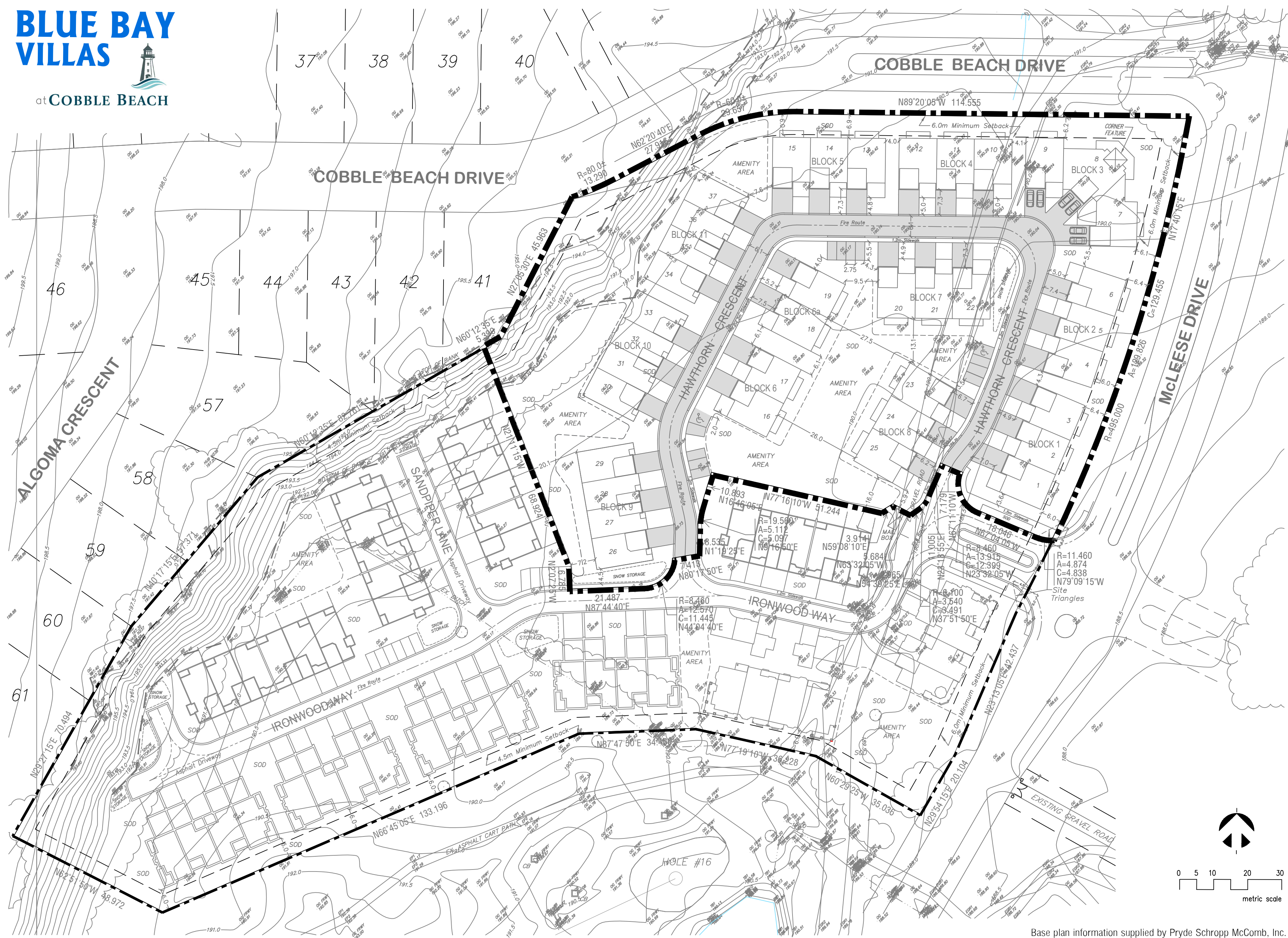

at COBBLE BEACH



COBBLE BEACH

GEORGIAN BAY'S EXTRAORDINARY GOLF RESORT COMMUNITY

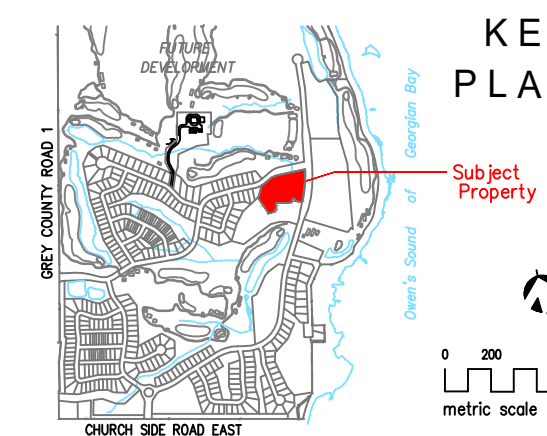

SITE STATISTICS

Total Building Area	(28.6%)	- 5,784.3 sq.m
Total Paved Area	(17.0%)	- 3,448.1 sq.m
Total Landscape Area	(38.3%)	- 7,754.4 sq.m
Amenity Area	(16.1%)	- 3,256.4 sq.m
Total Site Area	(100.0%)	- 20,243.8 sq.m

Residential Units	- 37 units
Site Density	- 18.3 u/ha

Parking Spaces Provided	
Interior to Unit -	- 68 spaces
Exterior to Unit -	- 68 spaces
Visitor Spaces Provided (2 Handicap)	- 13
Total Parking Spaces Provided	- 149 spaces
<small>(Minimum Parking stall dimension - 2.75m x 5.5m)</small>	

LEGEND

	Site Boundary
	Existing Elevation
	Pavement (Diagrammatic Only)

- ### NOTES:
- Parking will not be permitted along areas designated as Fire Routes.
 - All household garbage and recycling will be collected by Private Services.

REVISED SITE PLAN & DRAFT PLAN of CONDOMINIUM
 Part of Block 75 R.P.16M-15
 Part 2, Plan 16R-10059
 Township of Georgian Bluffs
 County of Grey

DESIGN PLAN SERVICES INC.
 Town Planning Consultants

900 The East Mall, Suite 300
 Toronto, ON M9B 6K2
 Telephone: 416.626.5445
 www.designplan.ca

1:750	Feb 4th/22	0518-B\41	1	Hp	RW
Scale	Date	Drawing Number	Rev.	Drawn	Design

Base plan information supplied by Pryde Schropp McComb, Inc.