

Legal Description
PART OF LOT 227, CONCESSION 2 SWTSR
PART 1 17R2183 AND AS IN R480846
(VILLAGE OF DUNDALK)
NOW IN THE TOWNSHIP OF SOUTHGATE
(GEOGRAPHIC TOWNSHIP OF PROTON)
COUNTY OF GREY

Owner's Certificate
I HEREBY AUTHORIZE MACNAUGHTON HERMSEN BRITTON CLARKSON PLANNING LIMITED TO SUBMIT THIS PLAN FOR APPROVAL.
DATE: _____
DOMENIC DE PALMA
2570970 ONTARIO INC.

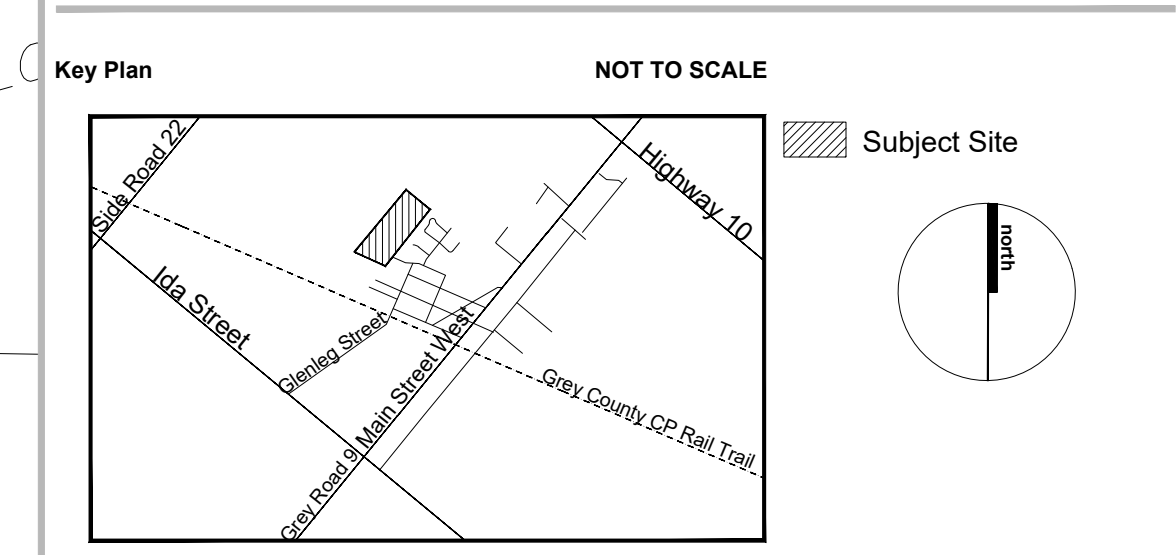

Legend

Revision No.	Date	Issued / Revision	By
A. As Shown		B. As Shown	C. As Shown
D. Residential, Stormwater Management		F. As Shown	G. As Shown
F. As Shown		H. Municipal Water Supply	I. Listowel Silt Loam
I. As Shown		J. As Shown	K. All Services As Required

Area Schedule

Description	Lots/Blocks	Units	Area
40' (12.2m) Single Detached	1-9, 31-33	12	0.64ha (1.57ac)
30' (10.0m) Single Detached	13-30	18	0.80ha (1.98ac)
19.5' (6.0m) Townhouses	34-57	24	0.44ha (1.08ac)
Senior Dwelling Blocks Townhouse Dwellings (20' (6.2m))	Block 10-11, 58-59	24	0.47ha (1.17ac)
Future Senior Dwelling Block	Block 10-11, 12, 58-59	32-34	0.83ha (2.06ac)
Roads	Street 'A', Street 'D'		1.14ha (2.82ac)
Stormwater Management	Block 60		0.19ha (0.46ac) 0.23ha (0.56ac)
6m Stormwater Management Connection	Block 61		0.04ha (0.10ac)
Additional Lands Owned by Applicant	Block 65		4.79ha (11.77ac)
0.3m & 0.5m Reserve	Block 62-64		0.01ha (0.02ac)
		86-88	8.88ha (21.94ac)



MHBC PLANNING URBAN DESIGN & LANDSCAPE ARCHITECTURE
230-7050 WESTON ROAD WOODBRIDGE, ON, L4L 8G7 | P: 905 761 5588 F: 905 761 5589 | WWW.MHBCPLAN.COM

Date	May 11, 2020
File No.	13126B
Plan Scale	1:750
Drawn By	T.H.
Checked By	D.K. & A.P.
Other	

Project
Part of Lot 227 Concession 2,
Township of Southgate,
County of Grey

File Name DRAFT PLAN OF SUBDIVISION **Dwg No.** 1 of 1

